

STANDARD ONE PIECE TANK RANGE.

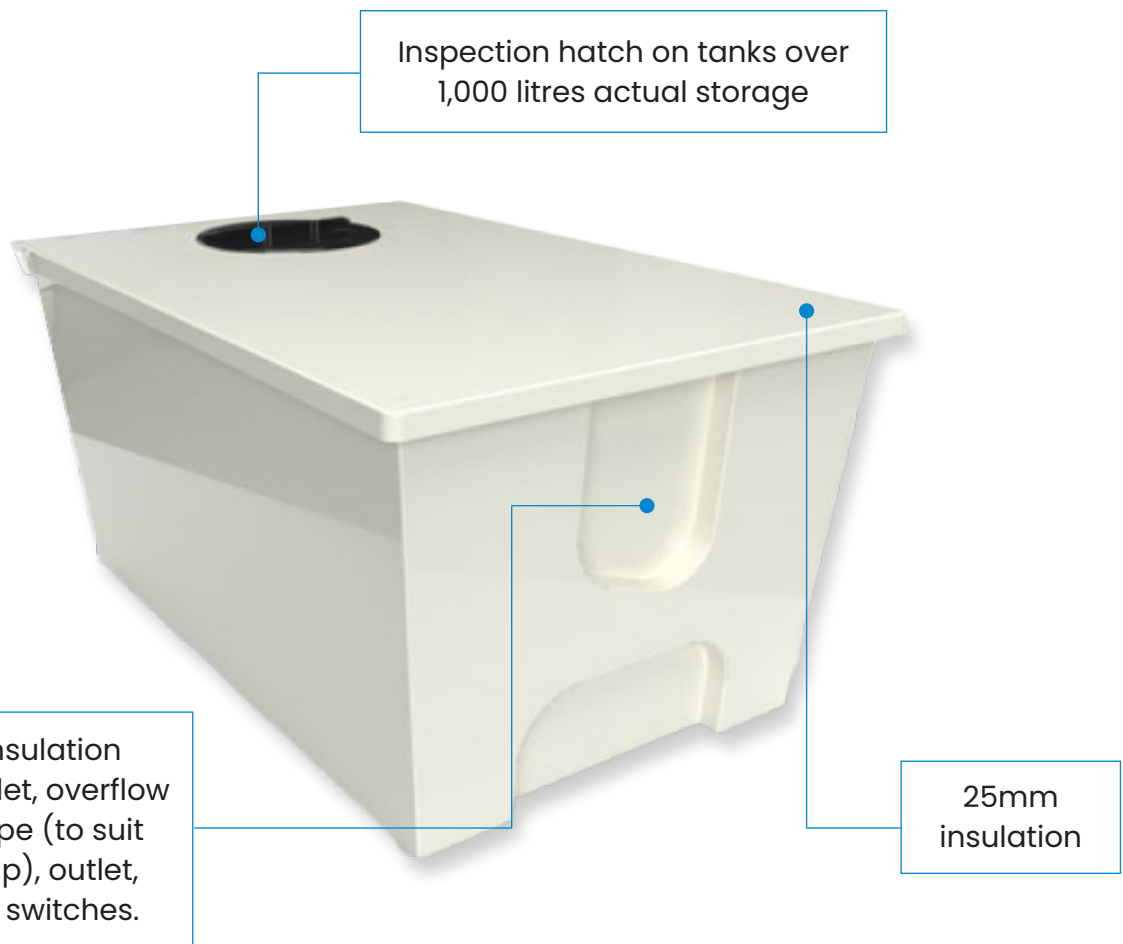

Why Purchase a Standard GRP One Piece Water Storage Tank?



- Nationwide next day delivery on selected stock models (*subject to availability*)
 - Long life corrosion free design – virtually **ZERO** maintenance
 - Suitable for internal or external applications
 - Full range of connections/ancillary items available
 - Close fitted sealed lid
 - Technical advice on all water storage projects

For more information contact us today at:
sales@trichel.ie or www.trichel.ie



STANDARD ONE PIECE TANK RANGE.



Tank Model	External Dimensions (L x W x H)	Nominal Capacity (Litres)	Drip Tray Required (as Standard)
TW45	495 x 370 x 345mm	45	✓
TW45	495 x 370 x 345mm (<i>Not Insulated</i>)	45	✓
TW180	700 x 575 x 575mm	180	✓
TW225	1200 x 535 x 480mm	225	✓
TW315	1240 x 585 x 585mm	315	✓
TW500	1130 x 755 x 840mm	500	✓
TW700	1645 x 1035 x 590mm	700	✓
TW970	1285 x 1000 x 965mm	970	✓
TW1000	1180 x 1180 x 1040mm	1000	✓
TW1500	1685 x 1185 x 1040mm	1500	✓
TW2000	2185 x 1185 x 1040mm	2000	✓
TW2250	1680 x 1180 x 1560mm	2250	✓
TW3000	2180 x 1180 x 1560mm	3000	✓
TW3600	2680 x 1830 x 1010mm	3600	✓
TW4500	2680 x 1830 x 1260mm	4500	✓
TW6000	2200 x 2200 x 1560mm	6000	✓

Many local authorities, consultants, engineers and contractors specify and use our fibreglass insulated F30 tanks, secure in the knowledge that both they and their clients are in safe hands, and helping them meet their health and safety obligations.

In order to comply with health and safety directives, which states that water, that may be consumed by humans, must be held in Insulated tanks, and that all tanks must meet the following criteria.

In accordance with Tricel's normal policy of product development these specifications are subject to change without notice.

- Factory insulated with CFC Free Foam on all sides
- Fibreglass in construction

- Lids must be sealed and insulated
- Suitable for Potable (drinking) water
- Tanks must have screened inlet and overflows
- Tanks to be insulated to reduce the risk of freezing in winter and assist in keeping the water temperature low in summer time
- Have suitable fibreglass condensation trays, plumbed to an overflow

Also from Tricel (Killarney)

- Sectional water storage tanks
- Metering cabinets (electrical and gas)
- Custom moulding, access chambers, safety products
- Underground and overground storage tanks
- Tricel Novo - wastewater treatment systems
- Kiosks
- Insulated housings



Please note: Insulation slows down, but does not prevent heat loss or heat gain, over protracted periods.
Additional information is available in BS 7491 & BS 6700.

Tricel (Killarney) Unlimited Company, Ballyspillane Industrial Estate, Killarney, Co. Kerry, Ireland.

Tel: +353 (0) 64 6632421 | Email: sales@tricel.ie | www.tricel.ie

In accordance with Tricel's normal policy of product development these specifications are subject to change without notice.